

---

*Comfort-Aire*®

 **Century**®

**MARS**®  
Delivering Confidence

---

REPLACEMENT PARTS LIST

**Single Zone Inverter Mini-Split  
Indoor Air Handler**

B-DVH18SF-1

# EXPLODED VIEW

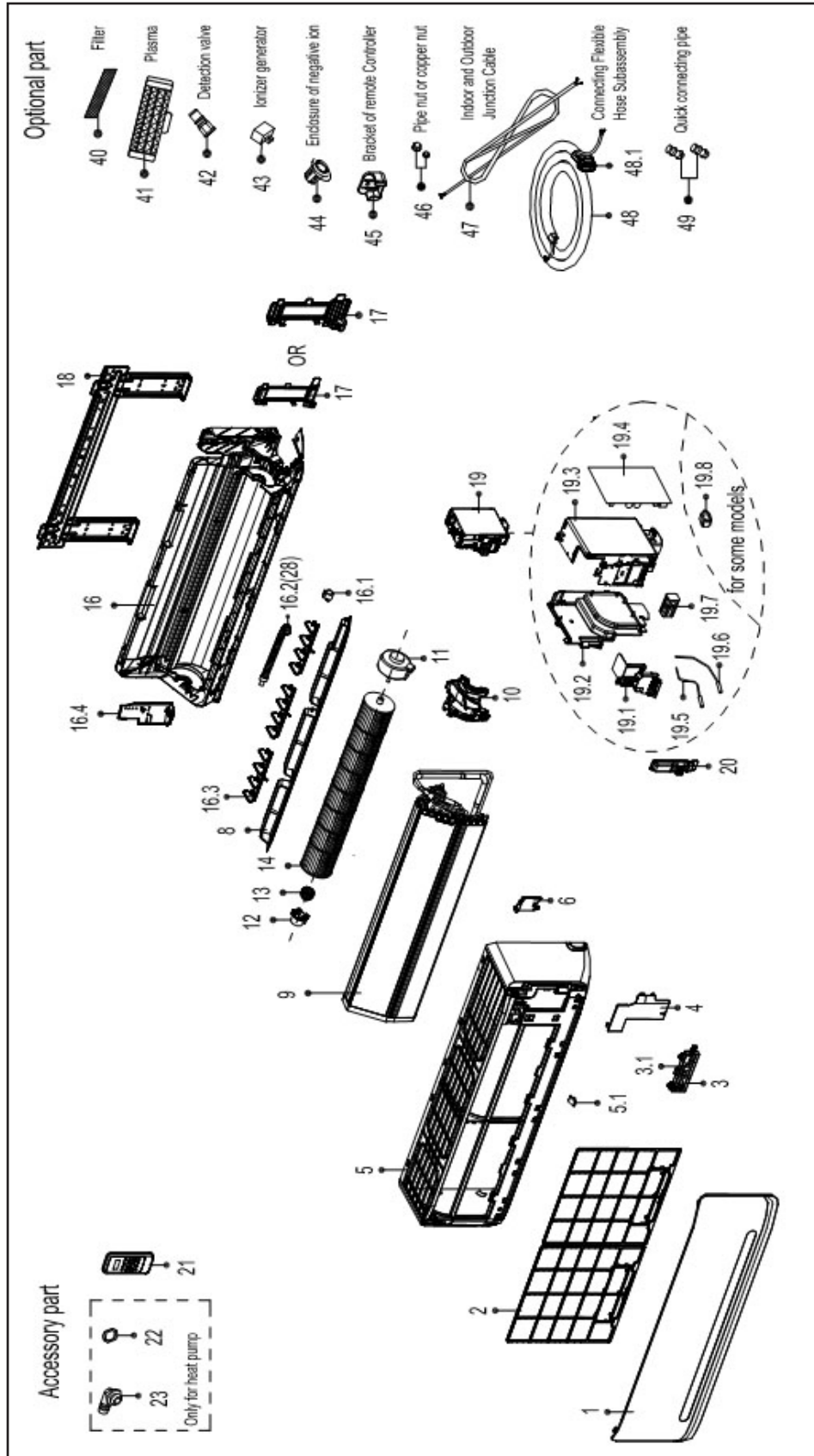

## REPLACEMENT PARTS

Location	Part Name	Quantity	Part No.
1	Panel assembly	1	12122000A49359
2	Filter	2	12100204000397
3	Indicator board assembly of Split Unit	1	17222000A01265
3.1	Display Panel Subassembly(Sticker)	1	17122000006863
4	E-Parts Cover Plate	1	12122000006755
5	Panel frame assembly	1	12122000002008
5.1	Screw Cap	1	12122000008242
6	Right Cover Plate of Chassis	1	12122000004592
8	Wind Guide	1	12122000006359
9	Evaporator Assembly	1	15822000006076
10	Motor Bearing Cover	1	12122000005538
11	Brushless DC Motor	1	11002015000139
12	Bearing base jacket	1	12122000000350
13	Bearing base	1	12622000000006
14	Cross-flow Window Rotor.	1	12100102000131
16	Chassis assembly	1	12122000A26278
17	Pipe clamp board	1	12122000012941
18	Installation Plate Subassembly	1	12222000000026
19	Electronic control box assembly	1	17222000009271
19.1	Upper Cover Board of Electrical Control Box	1	12122000004577
19.2	Left Side Plate of Electrical Control Box	1	12122000004639
19.3	Right Side Plate of E-Parts Box	1	12122000004632
19.4	Indoor main control board assembly	1	17122000018658
19.5	Room Temperature Sensor	1	11201007000085
19.6	Temperature Sensor	1	11201007000322
19.7	Wire holder (terminal strip)	1	17400401000006
20	Electrical Control Box Cover	1	12122000005020
21	Remote controller	1	17317000A19587
22	Seal ring	1	12600701000039
23	Drain hose	1	12100509000061
28	Drain Hose	1	12100501000032
40	Silver-ion Sterilizing Mesh	1	12100207000131

---

Due to ongoing product improvements, specifications and dimensions are subject to change and correction without notice or incurring obligations. Determining the application and suitability for use of any product is the responsibility of the installer. Additionally, the installer is responsible for verifying dimensional data on the actual product prior to beginning any installation preparations.

Incentive and rebate programs have precise requirements as to product performance and certification. All products meet applicable regulations in effect on date of manufacture; however, certifications are not necessarily granted for the life of a product. Therefore, it is the responsibility of the applicant to determine whether a specific model qualifies for these incentive/rebate programs.



1900 Wellworth Ave., Jackson, MI 49203 • Ph. 517-787-2100 • [www.marsdelivers.com](http://www.marsdelivers.com)

